

VRB-090 – 1-Stage Adapter Dimensions

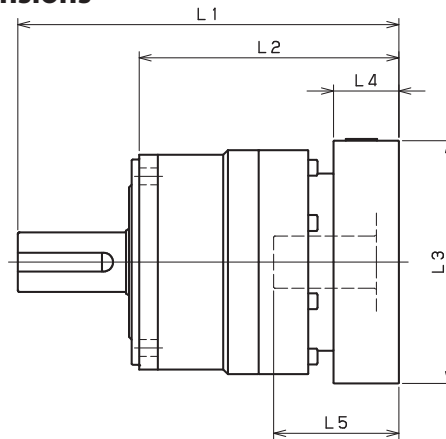

Model number	**: Adapter code	1-Stage					
		L1	L*	L2	L3	L4	L5
VRB-090-□-□-8** (Input shaft bore ≤ φ8)	AA·AC·AD·AF·AG·AL·AM·AN·AQ	--	--	--	--	--	--
	AB·AE·AH·AJ·AK	--	--	--	--	--	--
	BA·BB·BD·BE·BG·BH·BJ	--	--	--	--	--	--
	CA	--	--	--	--	--	--
VRB-090-□-□-14** (Input shaft bore ≤ φ14)	BA·BB·BD·BE·BF·BG·BH·BJ·BK·BP	143	126.5	95	□65	16.5	35
	BC·BH·BM·BN	148	126.5	100	□65	21.5	40
	CA·CC	143	126.5	95	□70	16.5	35
	DA·DB·DC·DD·DF·DH·DJ	143	126.5	95	□80	16.5	35
	EA·EB·EC·EF·EG·EK·EL	143	126.5	95	□90	16.5	35
	FA	143	126.5	95	□100	16.5	35
	FB	153	126.5	105	□100	26.5	45
JA	158	126.5	110	□150	31.5	50	
VRB-090-□-□-19** (Input shaft bore ≤ φ19)	DA·DB·DC	153	128	105	□80	25	50
	EB·ED	153	128	105	□90	25	50
	FA	153	128	105	□100	25	50
	FB	163	128	115	□100	35	60
	GA·GC·GH	158	128	110	□115	30	55
	GB·GD·GJ	153	128	105	□115	25	50
	GE·GF	163	128	115	□115	35	60
	HA	153	128	105	□130	25	50
	HB	168	128	120	□130	40	65
	HC·HD·HE	158	128	110	□130	30	55
	JA	163	128	115	□150	35	60
JB	168	128	120	□150	40	65	
VRB-090-□-□-28** (Input shaft bore ≤ φ28)	FA·FB·FC	170	135	122	□100	35	67
	FD·FE	165	135	117	□100	30	62
	GA·GB·GC·GD·GE·GF·GG·GH	170	135	122	□115	35	67
	HA·HC·HD	170	135	122	□130	35	67
	HB	180	135	132	□130	45	77
	HE	185	135	137	□130	50	82
	HF	165	135	117	□130	30	62
	JA·JB·JC·JF	170	135	122	□150	35	67
	JD	190	135	142	□150	55	87
JE	180	135	132	□150	45	77	

*1) Single reduction : 1/3~ 1/10

*2) Bushing will be inserted to adapt to motor shaft

For an explanation on the Adapter Flange Code, please turn to page 422.

A more comprehensive adapter flange offering can be found using the NIDEC-SHIMPO Online Selector Tool. The variety is constantly expanding and being updated on the Selector Tool. If you have any questions or need any support, contact NIDEC-SHIMPO.

VRB-090 – 2-Stage Adapter Dimensions

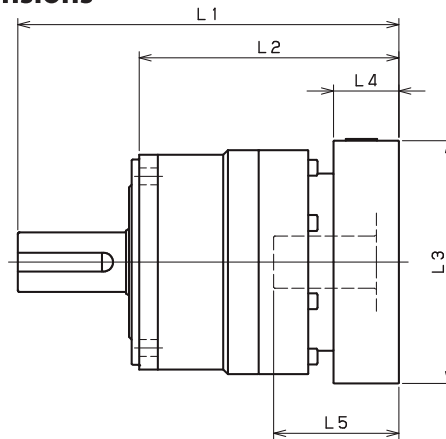

Model number	**: Adapter code	2-Stage					
		L1	L*	L2	L3	L4	L5
VRB-090-□-□-8** (Input shaft bore ≤ φ8)	AA·AC·AD·AF·AG·AL·AM·AN·AQ	160	144.5	112	□52	15.5	32
	AB·AE·AH·AJ·AK	165	144.5	117	□52	20.5	37
	BA·BB·BD·BE·BG·BH·BJ	160	144.5	112	□60	15.5	32
	CA	165	144.5	117	□70	20.5	37
VRB-090-□-□-14** (Input shaft bore ≤ φ14)	BA·BB·BD·BE·BF·BG·BH·BJ·BK·BP	165	148.5	117	□65	16.5	35
	BC·BH·BM·BN	170	148.5	122	□65	21.5	40
	CA·CC	165	148.5	117	□70	16.5	35
	DA·DB·DC·DD·DF·DH·DJ	165	148.5	117	□80	16.5	35
	EA·EB·EC·EF·EG·EK·EL	165	148.5	117	□90	16.5	35
	FA	165	148.5	117	□100	16.5	35
	FB	175	148.5	127	□100	26.5	45
VRB-090-□-□-19** (Input shaft bore ≤ φ19)	JA	180	148.5	132	□150	31.5	50
	DA·DB·DC	175	150	127	□80	25	50
	EB·ED	175	150	127	□90	25	50
	FA	175	150	127	□100	25	50
	FB	185	150	137	□100	35	60
	GA·GC·GH	180	150	132	□115	30	55
	GB·GD·GJ	175	150	127	□115	25	50
	GE·GF	185	150	137	□115	35	60
	HA	175	150	127	□130	25	50
	HB	190	150	142	□130	40	65
	HC·HD·HE	180	150	132	□130	30	55
VRB-090-□-□-28** (Input shaft bore ≤ φ28)	JA	185	150	137	□150	35	60
	JB	190	150	142	□150	40	65
	FA·FB·FC	194	159	146	□100	35	67
	FD·FE	189	159	141	□100	30	62
	GA·GB·GC·GD·GE·GF·GG·GH	194	159	146	□115	35	67
	HA·HC·HD	194	159	146	□130	35	67
	HB	204	159	156	□130	45	77
	HE	209	159	161	□130	50	82
	HF	189	159	141	□130	30	62
VRB-090-□-□-28** (Input shaft bore ≤ φ28)	JA·JB·JC·JF	194	159	146	□150	35	67
	JD	214	159	166	□150	55	87
	JE	204	159	156	□150	45	77

*1) Double reduction : 1/15~ 1/100

*2) Bushing will be inserted to adapt to motor shaft

For an explanation on the Adapter Flange Code, please turn to page 422.

A more comprehensive adapter flange offering can be found using the NIDEC-SHIMPO Online Selector Tool. The variety is constantly expanding and being updated on the Selector Tool. If you have any questions or need any support, contact NIDEC-SHIMPO.